

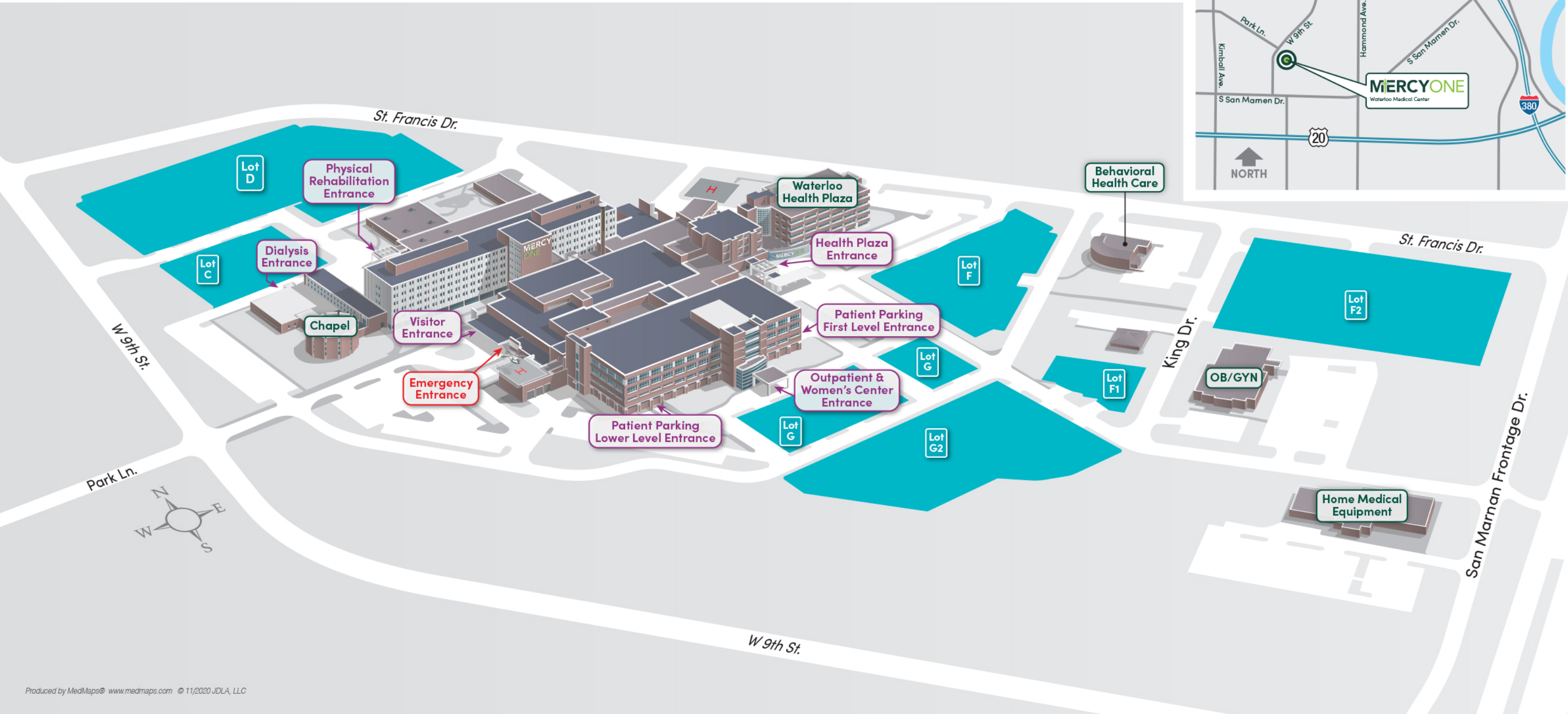

MercyOne Waterloo Medical Center is a 366-bed, full service, multi-specialty hospital that provides inpatient and outpatient health care to support the community's health care needs. Services include intensive care; operating and recovery rooms for both inpatient and outpatient surgeries and procedures; a CARF accredited rehabilitation program serving inpatients and outpatients; accredited cancer center and breast care center; women's health care including OB/GYN and midwifery, birth center and the area's only Integrated Neonatal Intensive Care program; comprehensive imaging; laboratory; respiratory therapy; heart care including general interventional cardiology and electrophysiology; inpatient and outpatient behavioral health care including a treatment program; and pharmacy. In addition, MercyOne Waterloo Medical Center provides complete emergency care including emergency ground transport, with air ambulance available upon request.



## VISITOR GUIDE



**Waterloo Medical Center**  
3421 West 9th Street  
Waterloo, IA 50702  
(319) 272-8000  
[MercyOne.org](http://MercyOne.org)





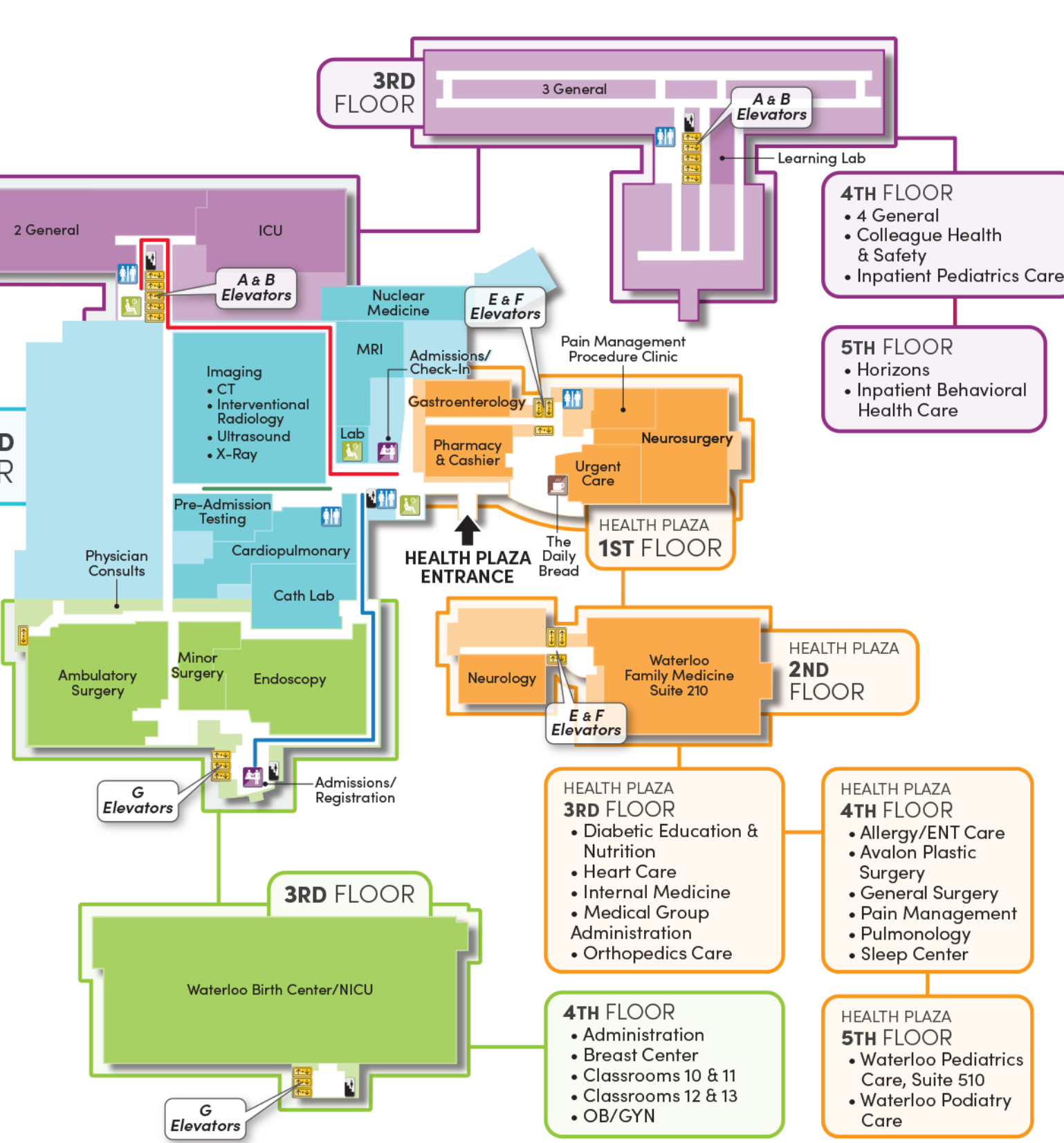
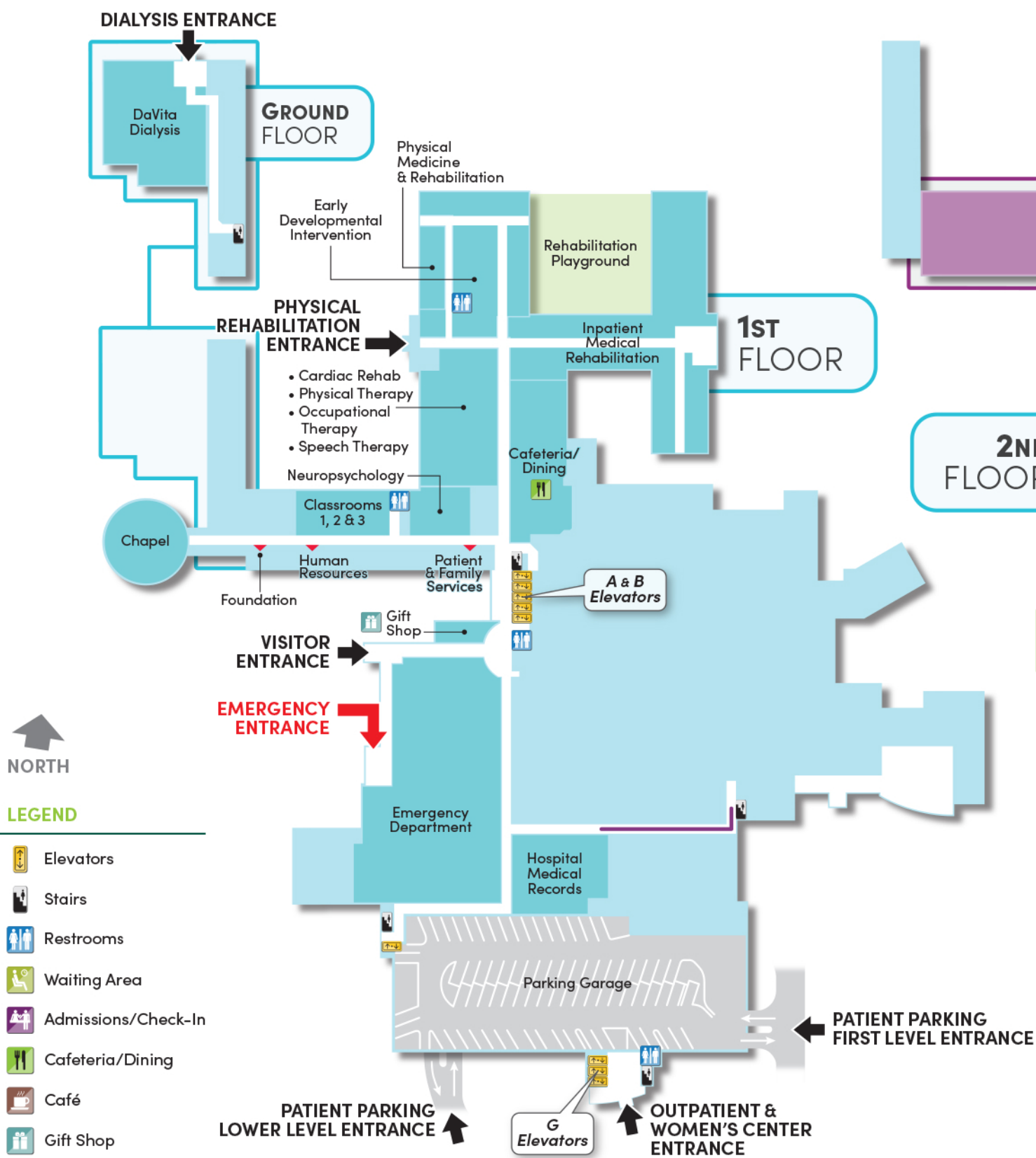

Department	Floor
<b>WATERLOO MEDICAL CENTER (HOSPITAL)</b>	
2 General	2nd
3 General	3rd
4 General	4th
Administration	4th
Cafeteria/Dining	1st
Cardiac Rehab/Physical, Occupational, Speech Therapy	1st
Cardiopulmonary	2nd
Chapel	1st
Classrooms 1 – 3	1st
Classrooms 10 – 13	4th
Colleague Health & Safety	4th
DaVita Dialysis	Ground
Early Developmental Intervention (EDI)	1st
Emergency Department	1st
Endoscopy	2nd
Horizons	5th
Hospital Medical Records	1st
Human Resources	1st
ICU	2nd
Imaging	2nd
Inpatient Behavioral Health Care	5th
Inpatient Pediatrics Care	4th
Lab	2nd
Learning Lab	3rd
Minor Surgery	2nd
MRI	2nd
Neuropsychology	1st
Nuclear Medicine	2nd
OB/GYN	4th
Physical Medicine & Rehabilitation	1st
Pre-Admission Testing	2nd
Waterloo Birth Center	3rd
Waterloo Breast Center	4th
<b>WATERLOO HEALTH PLAZA (MEDICAL OFFICES)</b>	
Allergy/ENT Care	4th
Avalon Plastic Surgery	4th
Clinic Medical Records	Lower
Diabetic Education & Nutrition	3rd
Family Medicine, Suite 210	2nd
Gastroenterology	1st
General Surgery	4th
Heart Care	3rd
Internal Medicine, Suite 300	3rd
Medical Group Administration	3rd
Neurology	2nd
Neurosurgery	1st
Northern Iowa Pain Management	2nd
Orthopedics Care	3rd
Pain Management	1st/4th
Pediatrics Care, Suite 510	5th
Pharmacy & Cashier	1st
Podiatry Care	5th
Pulmonology	4th
Sleep Center	4th
Urgent Care	1st

**LEGEND**

- Elevators
- Stairs
- Restrooms
- Waiting Area
- Admissions/Check-In
- Cafeteria/Dining
- Café
- Gift Shop